

TECHNICAL DATA/SPECIFICATION

MODEL: SRE-3050 ELAN STRAIGHT RAIL STAIRLIFT, PRIVATE RESIDENCE ONLY

RATED LOAD: 300 LBS, ONE PASSENGER

POWER SOURCE: 24 VOLT DC COMPRISED OF (2) 3 AMP/HR
12 VOLT SEALED BATTERIES
105-230 VOLT AC 0.6 AMP, 24 VOLT DC 1 AMP
CONTINUOUS MONITORING CHARGER.

DRIVE: 24 VOLT DC DIRECT DRIVE SELF LOCKING POSITIVE GEARED MOTOR,
2 POLE RATED .18 HP MAX., RIGHT ANGLE WORM GEARBOX,
50Nm (442in.lb.) TORQUE MAX., 25.5 RPM SPEED MAX.,
16 AMP CURRENT MAX.

SUSPENSION: RACK & PINION - INTEGRATED 8DP GEAR RACK
ON RAIL WITH SPUR GEAR ON THE OUTPUT SHAFT
OF GEARBOX.

BRAKING: DYNAMIC MOTOR BRAKING THROUGH THE MOTOR
CONTROLLER, WORM GEAR, ELECTRO-MECHANICAL
MOTOR BRAKE AND OVERSPEED PROTECTION.

CONTROLS: CONTINUOUS PRESSURE ROCKER SWITCH LOCATED
ON THE ARMREST AND WALL MOUNTED CALL/SEND
CONTROLS LOCATED AT BOTH THE TOP AND BOTTOM
LANDINGS.

ANGLES: 22° TO 52°, RIGHT OR LEFT HAND ORIENTATIONS.

FINAL LIMIT SWITCH: STANDARD

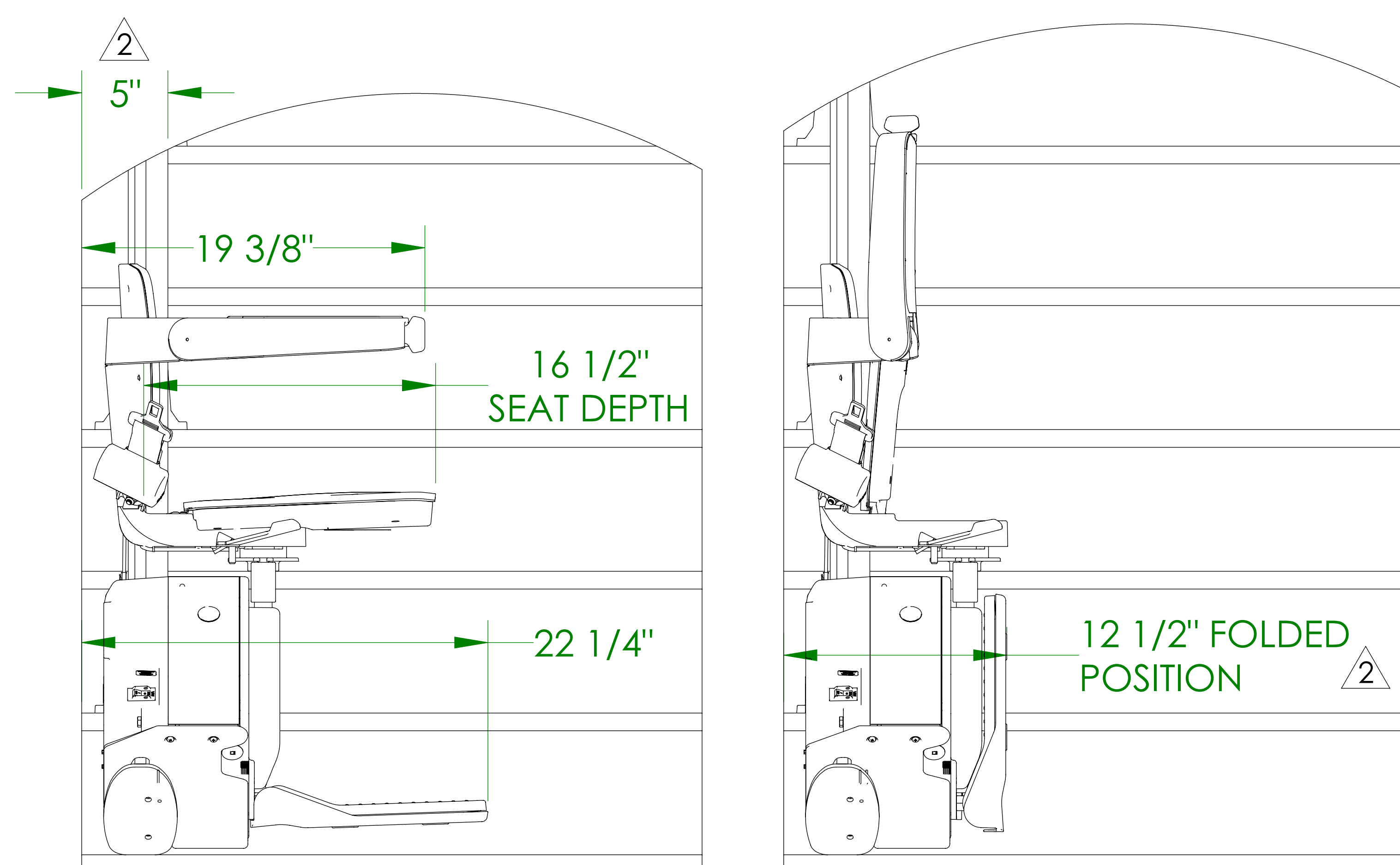
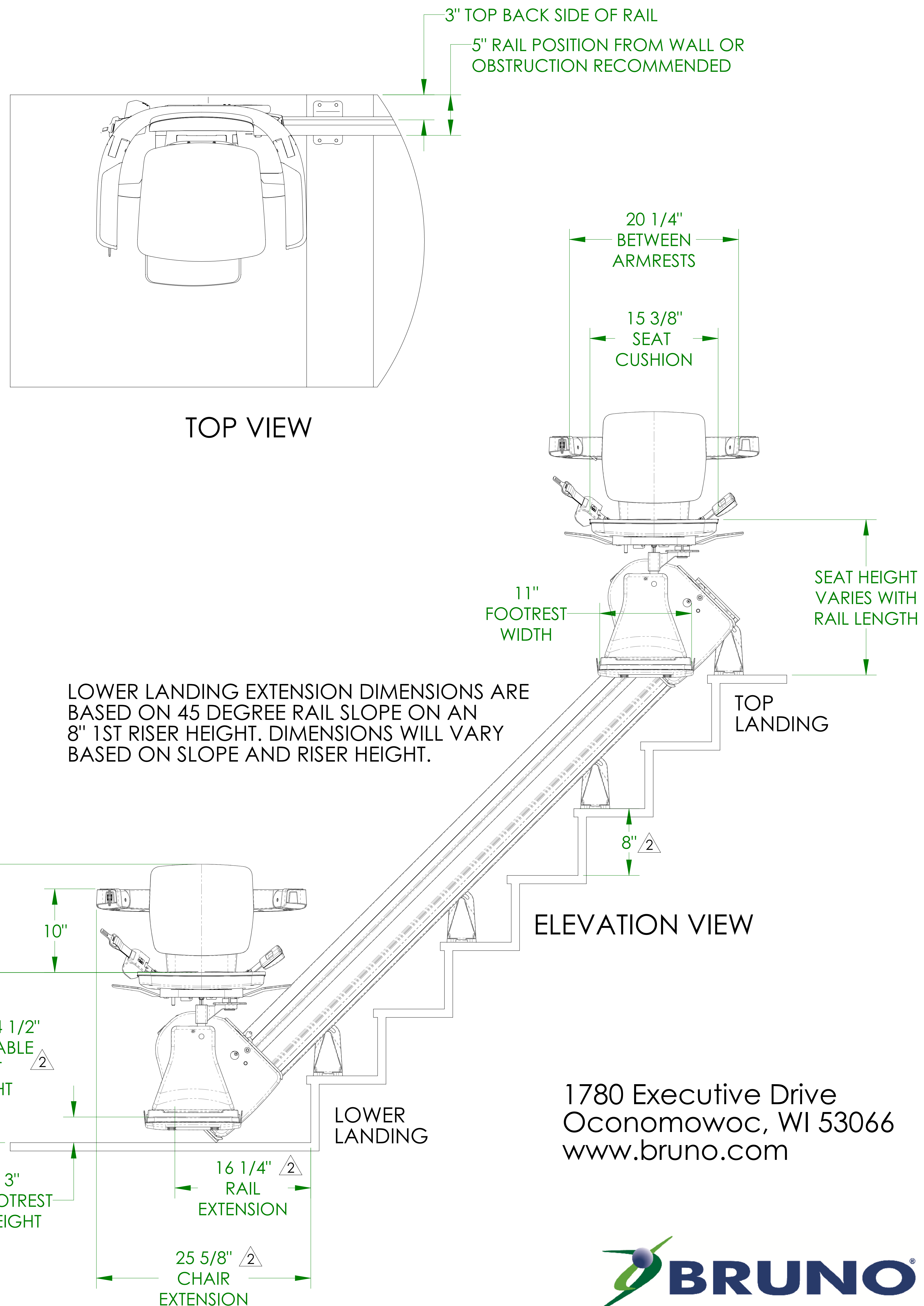

SIDE VIEWS

DIMENSIONS SHOWN IN SIDE VIEWS \triangle ARE BASED ON 5" RAIL POSITION FROM WALL OR OBSTRUCTION

1780 Executive Drive
Oconomowoc, WI 53066
www.bruno.com



©Bruno Independent Living Aids, Inc.

ILS-01459
SHEET 1 OF 3
REV. 2 (7632)(08/15/22)(JCR)

SRE-3050

DISTANCE FROM WALL - SEAT SWIVELED

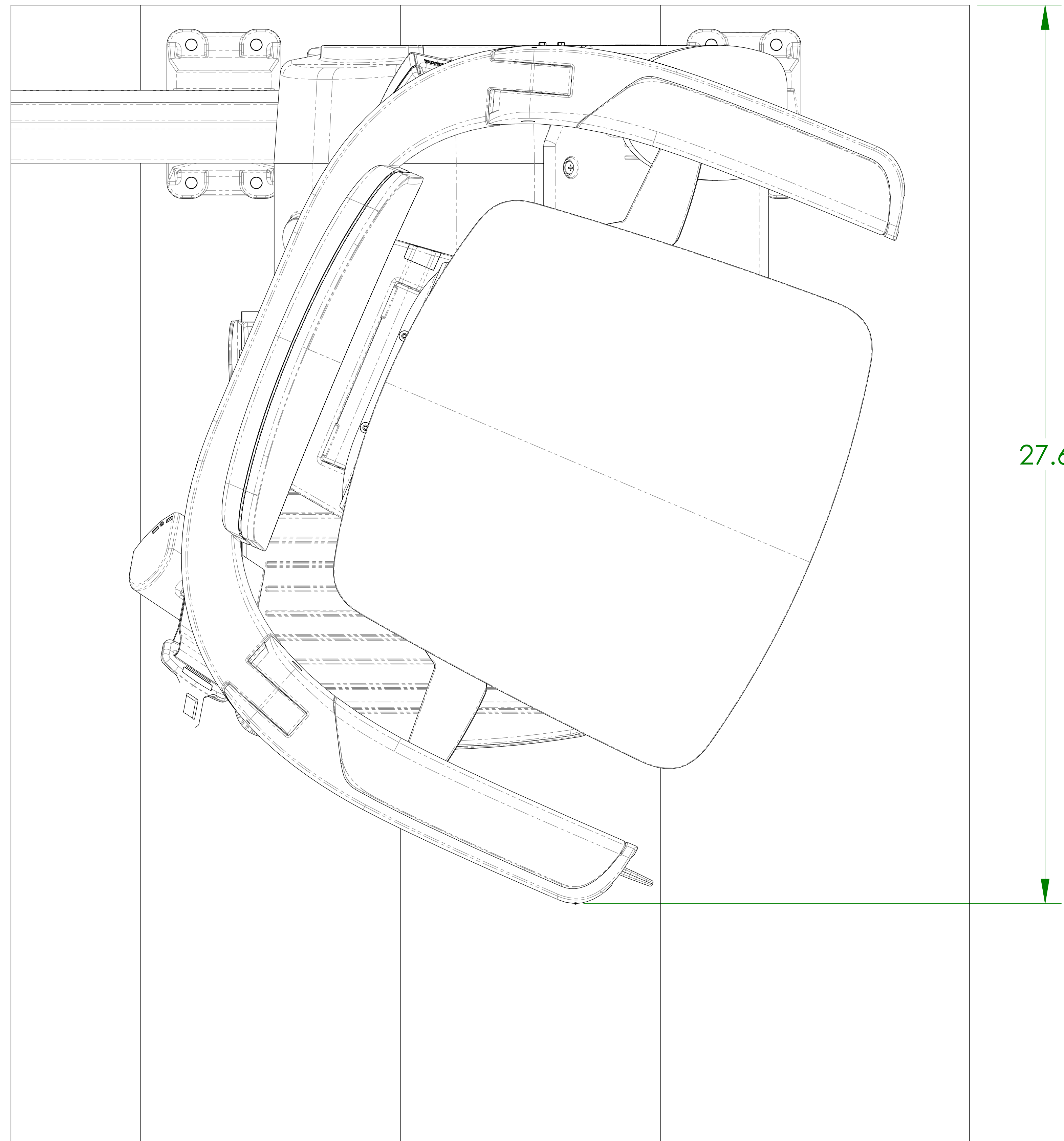

SEAT SWIVELED 67°

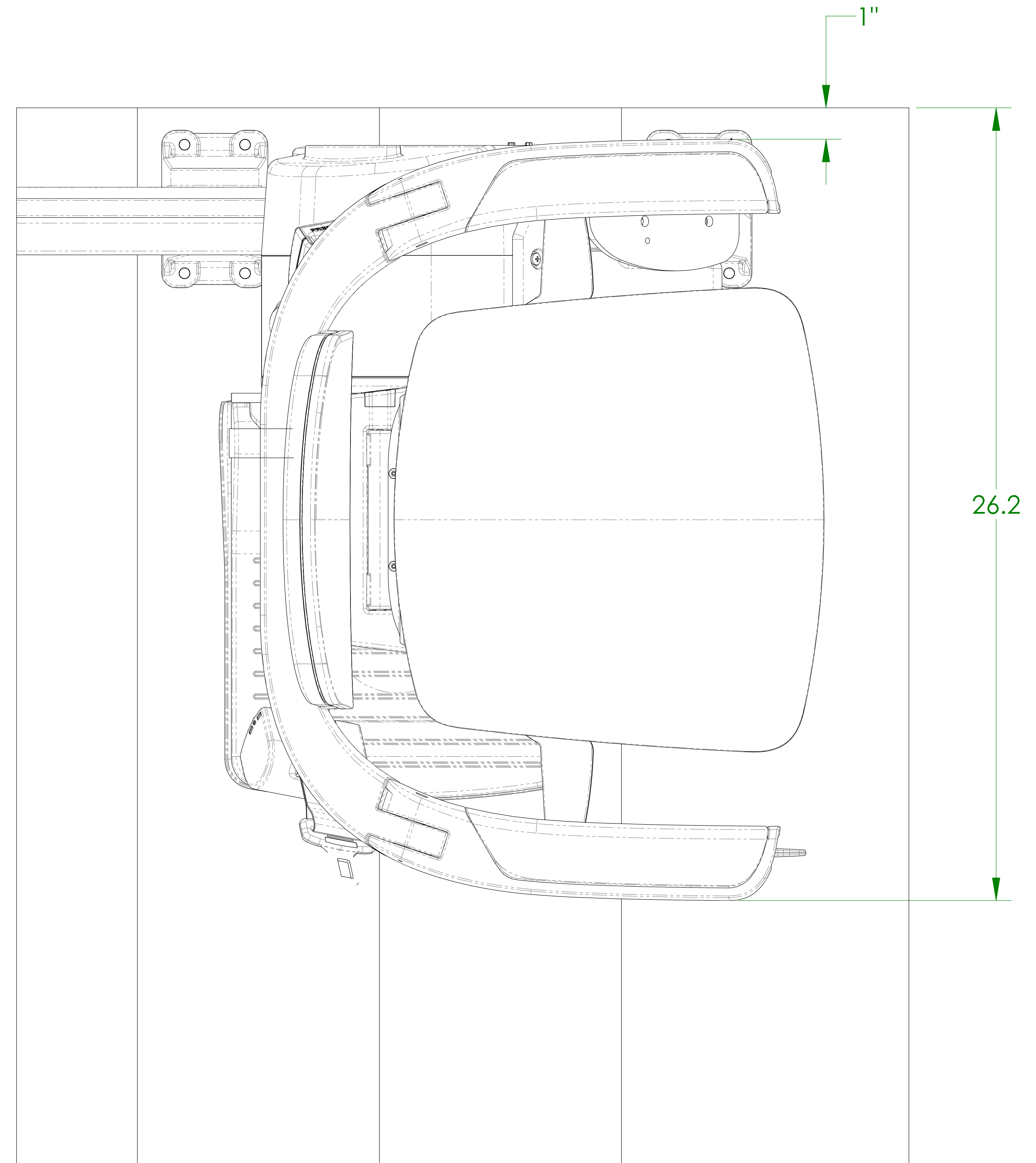

SEAT SWIVELED 90°

1780 Executive Drive
Oconomowoc, WI 53066
www.bruno.com

ILS-01459
SHEET 2 OF 3
REV. 2 (7632)(08/15/22)(JCR)



©Bruno Independent Living Aids, Inc.

SRE-3050 FOLDING RAIL

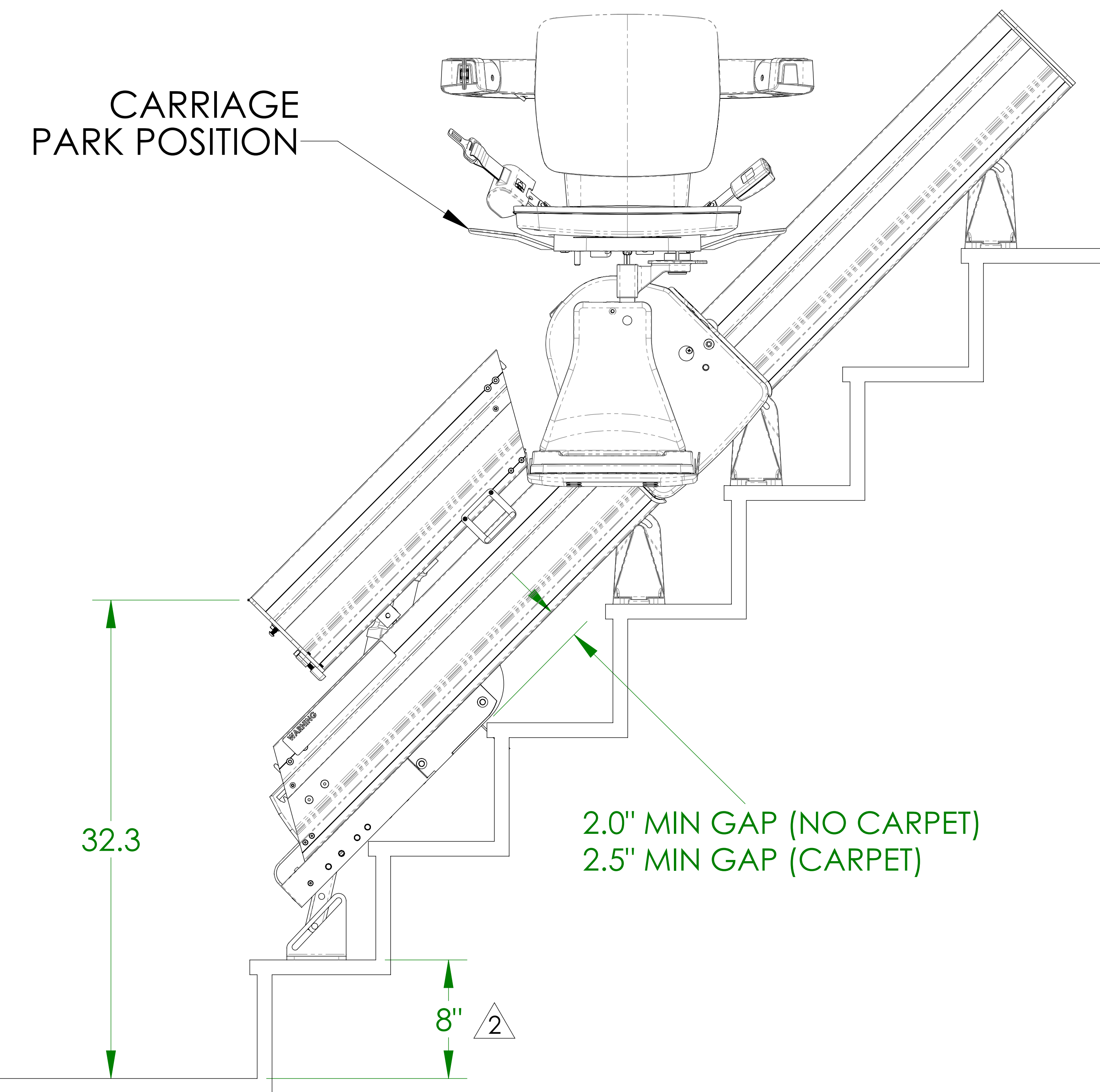
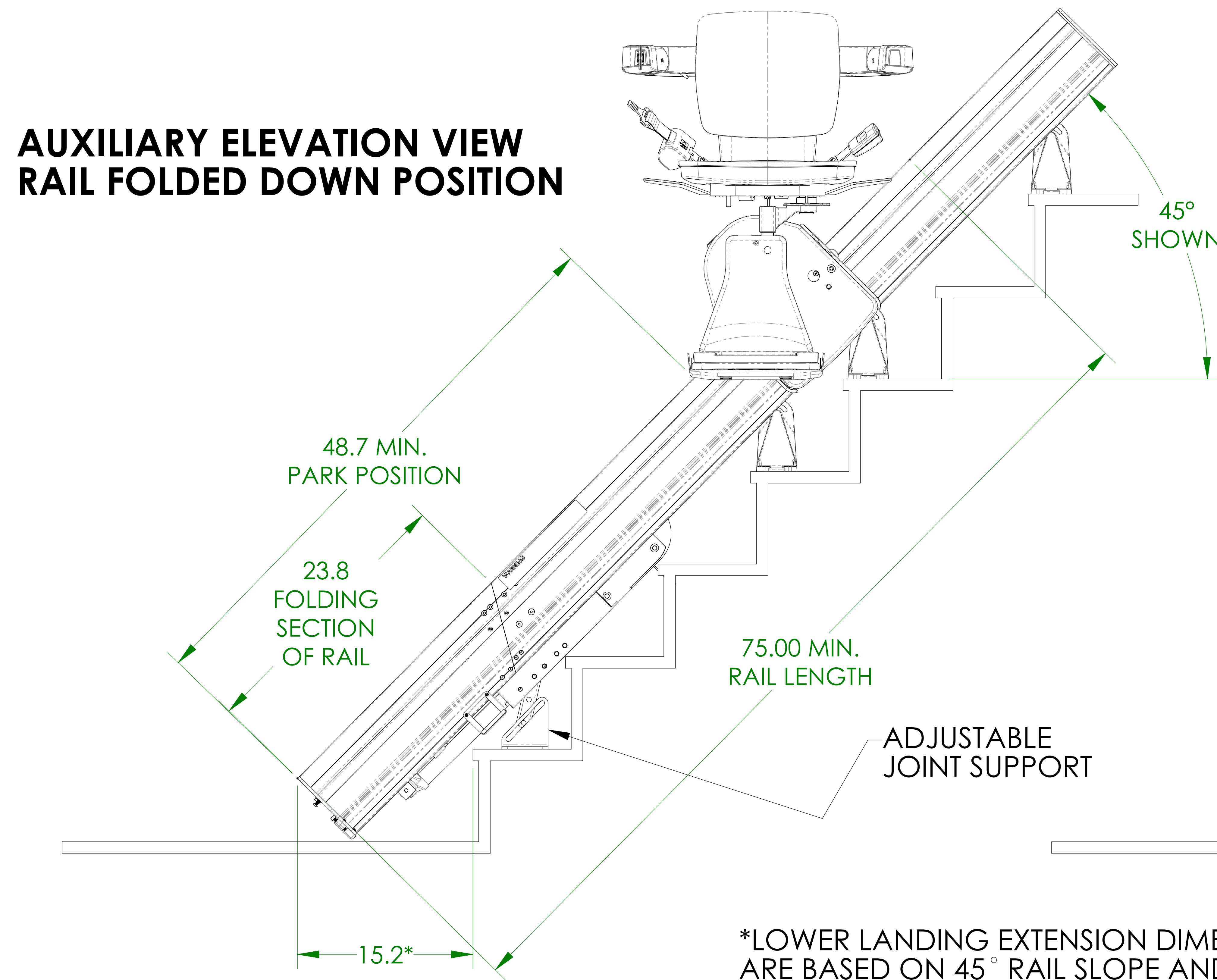
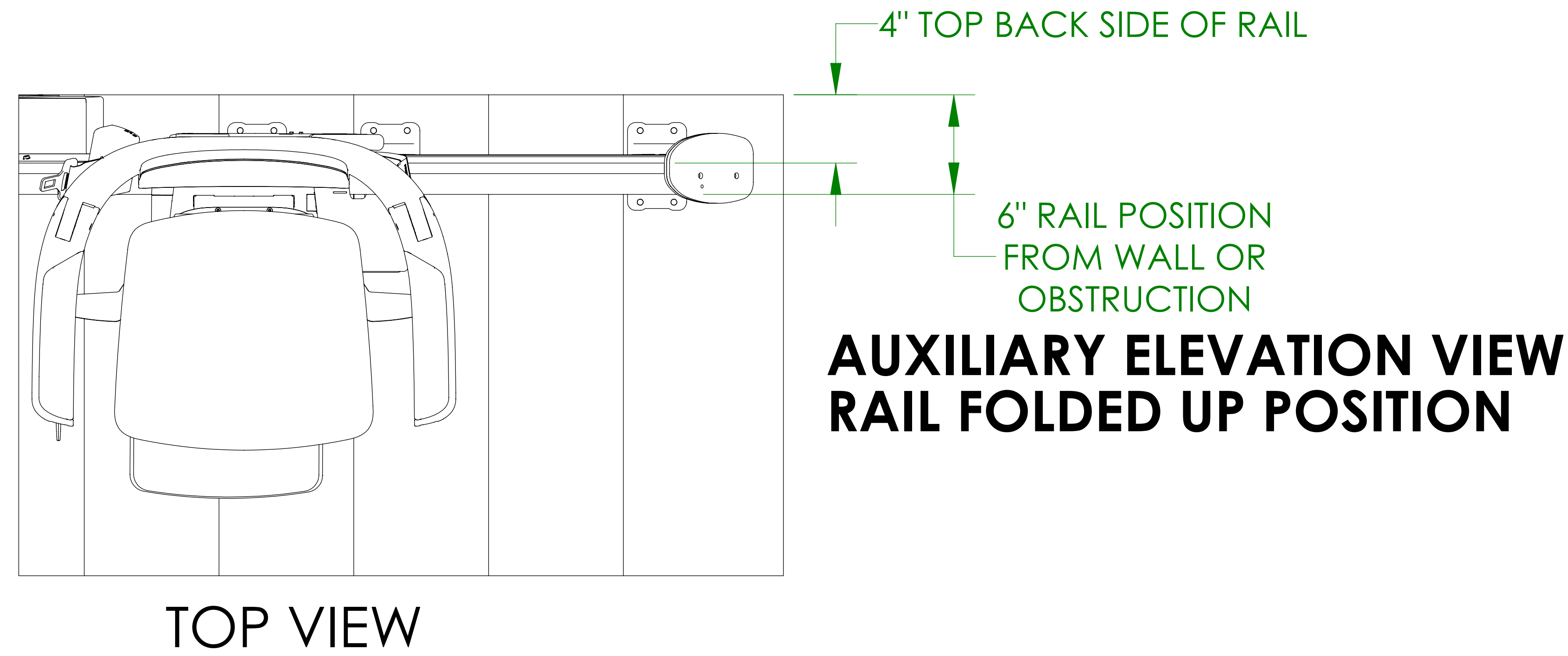

*LOWER LANDING EXTENSION DIMENSIONS ARE BASED ON 45° RAIL SLOPE AND 8" RISER HEIGHT. DIMENSIONS WILL VARY BASED ON SLOPE AND RISER HEIGHT.

1780 Executive Drive
Oconomowoc, WI 53066
www.bruno.com